

# ***TWIN HEAD COMPRESS MACHINE***



+66 34 854716 to 7

[www.yfm.co.th](http://www.yfm.co.th)

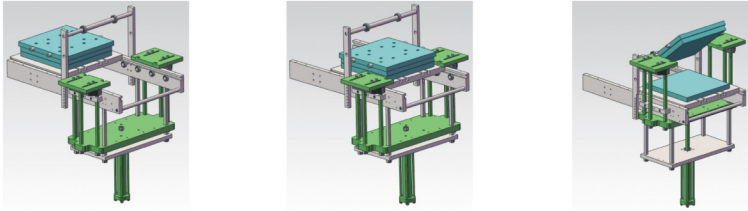
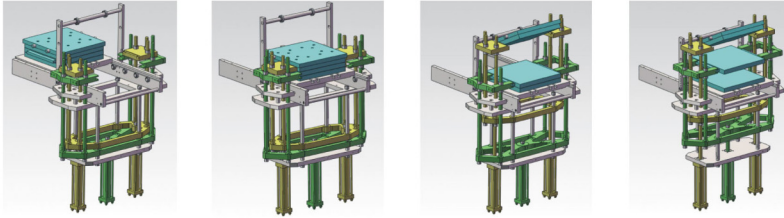
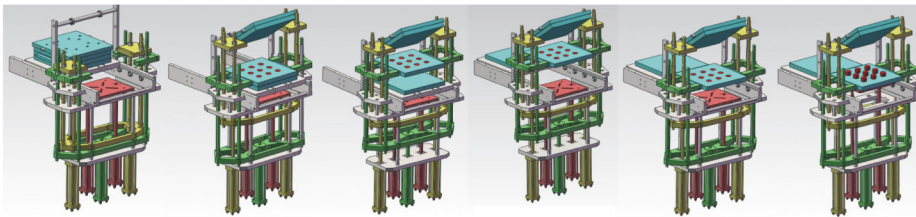

**2RT****3RT****4RT**

# MACHINE SPECIFICATION

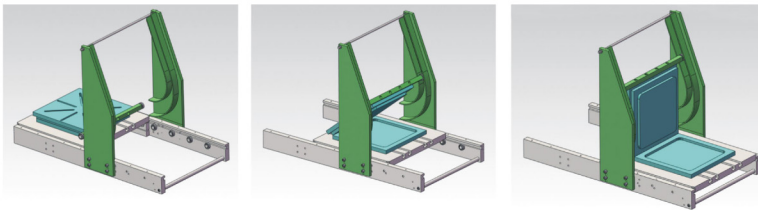

**Rail sliding device**

## Overview

Compressor is a product forming machine which uses 2 or more plates of mold, which are pressed by hydraulic system. When the pressure is being transferred to the mold, compound rubber will be forced to fill up the empty space of the mold, and the heat from the mold will cause the rubber to become stable.

Model		YF-HM-100-2H	YF-HM-200-2H	YF-HM-300-2H	YF-HM-400-2H
Clamping Force	(kN)	1000	2000	3000	4000
Clamping Stroke	(mm)	300	300	350	400
Rapid clamping speed	(mm/s)	≥50	≥50	≥40	≥40
Heating Plate Size	(mm)	500 x 500	550 x 600	650 x 700	850 x 1000
Heating Plate Spacing	(mm)	200-400	180-480	300-500	300-500
Max Temperature	(°C)	250	250	250	250
Max ejector force	(kN)	60	60	60	120
Motor Power	(kW)	4 + 4	5.5 + 5.5	7.5 + 7.5	7.5 + 7.5
Heating Power	(kW)	13.8 + 13.8	18.3 + 18.3	23.7 + 23.7	39.6 + 39.6
Machine Dimension	(mm)	3500L x 2270W x 1775H	3680L x 2470W x 2100H	4000L x 2750W x 2400H	4200L x 3800W x 2650H
Oil Tank Capacity	(L)	350	350	400	540

\*\*The Above Specification is our Standard Specification.

\*\*\*For Special Specification/ Dimension, Please contact our personnels.

**YFM** YONG FONG MACHINERY CO., LTD.

38/5 Moo 1 Leabkhlomgmunprarom Rd., Nadee, Aumpermuang Samutsakorn, Samutsakorn 74000.Thailand  
Tel : +66 34 854716 to 7, +66 34 466282 to 3 Fax : +66 34 854718, +66 34 466345 yfmsales@gmail.com www.yfm.co.th